

F435 BORDATORE PER ELASTICO

BINDER FOR ELASTIC

Per macchine piane zig zag
For flat bed zig zag machines

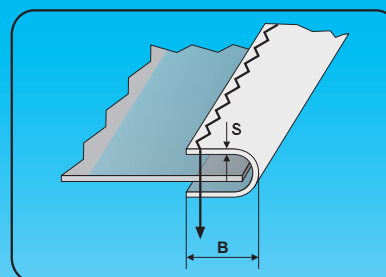
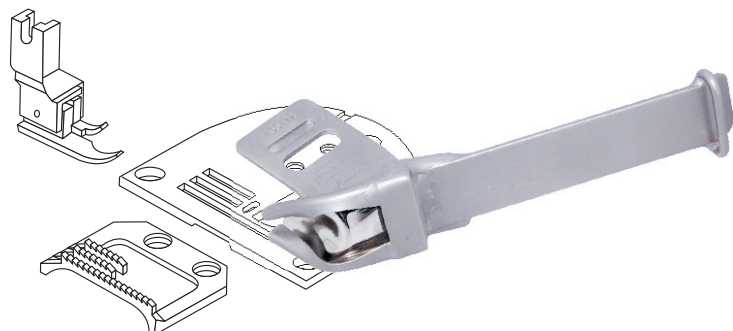

GRUPPI COMPLETI - SEPARATI (Placca, Griffa, Piedino) COMPLETE SETS - SEPARATED (Needle plate, Feed dog, Foot)

		PLACCA <i>Needle Plate</i>	GRIFFA <i>Feed Dog</i>	PIEDINO <i>Foot</i>
- BERNINA 217 (zig-zag)	cod. 15490	cod. 15492	cod. N602ZZ	
- BROTHER 856 (zig-zag)	cod. 15520	cod. 15521	cod. 15522	
- DÜRKOPP 265 (zig-zag)	cod. 15510	cod. 15511	cod. N602ZZ	
- JUKI LZ2280, 2290 (zig-zag)	cod. 15520	cod. 15521	cod. 15522	
- NECCHI 720, 750 (zig-zag)	cod. 15560	cod. 15561	cod. N602ZZ	
- PFAFF 138, 238 (zig-zag)	cod. 15600	cod. 15601	-----	
- PFAFF 438 (zig-zag)	cod. 15610	cod. 15611	cod. N602ZZ	
- REFREY 930 (zig-zag)	cod. 15490	cod. 15492	cod. N602ZZ	
- SINGER 457 (zig-zag)	cod. 15520	cod. 15521	cod. 15522	

Codice	Entrata (A) (tape size) (mm) (inch)	Lav. finito (B) (finished size) (mm) (inch)	Spessore (S) (thickness)
F435/12	12 15/32	6 15/64	2 5/64
F435/13	13 33/64	6,5 1/4	2 5/64
F435/14	14 9/16	7 9/32	2 5/64
F435/15	15 19/32	7,5 19/64	2 5/64
F435/16	16 5/8	8 5/16	2 5/64
F435/17	17 21/32	8,5 21/64	2 5/64
F435/18	18 23/32	9 11/32	2 5/64
F435/20	20 25/32	10 3/8	2 5/64
F435/22	22 7/8	11 7/16	2 5/64
F435/25	25 1	12,5 1/2	2 5/64
F435/30	30 1-3/16	15 5/8	2 5/64